

audioengine 5+ Classic



Premium Home Music System

Quickstart Guide

Welcome to the Audioengine family and congratulations on your purchase of the Audioengine 5+ Home Music System!

The Audioengine team is dedicated to bringing you the highest-quality listening experience possible and the Audioengine 5+ speakers were designed with the same attention to detail and operational simplicity as all other Audioengine products.

As with our other past efforts, we want to thank our customers, distributors, and resellers for the inspiration to create another great Audioengine product.

What's in the box

A5+ powered (left) speaker
A5+ passive (right) speaker
Remote control
Speaker wire, 3.75 meters (~12.3ft)
AC power cord
Mini-jack audio cable, 2 meters (~6.5 feet)
RCA audio cable, 2 meters (~6.5 feet)
Microfiber speaker bags
Microfiber cable bag
Quickstart guide

Features

Built-in analog power amplifiers
Dual analog inputs and variable audio output
Hand-built cabinets and high-quality connectors
Custom aramid fiber woofers and silk dome tweeters
Remote control

Safety Instructions

1. Please read these instructions before using this product.
2. Keep these instructions for future reference.
3. Heed all warnings on the product and in this guide.
4. Follow all instructions.
5. Do not use this apparatus near water or moisture.
6. Clean only with a dry cloth and as directed by the manufacturer.
7. Do not block any ventilation openings. Install in accordance with the manufacturer's instructions.
8. Do not install near any heat sources, such as radiators, heat registers, stoves or other apparatus that produce heat.
9. Do not defeat the safety purpose of the polarized or grounding-type plug. A polarized plug has two blades with one wider than the other. A grounding-type plug has two blades and a third grounding prong. The wider blade or third prong are provided for your safety.
10. Protect the power cord from being walked on or pinched, particularly at plugs, convenience receptacles, and the point where they exit from the apparatus.
11. Use only attachments or accessories specified by the manufacturer.
12. Use only with the cart, stand, tripod, bracket or table specified by the manufacturer or sold with the apparatus. When a cart is used, use caution when moving the cart/apparatus combination to avoid injury from tip-over.
13. Unplug this apparatus during lightning storms or when unused for long periods of time to prevent damage to this product.
14. Refer all servicing to qualified service personnel. Servicing is required when the apparatus has been damaged in any way such as power supply cord or plug is damaged, liquid has been spilled or objects have fallen into the apparatus, the apparatus has been exposed to rain or moisture, does not operate normally, or has been dropped.

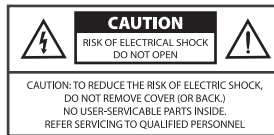

Unpacking

Your speakers were carefully tested and inspected before packaging and shipping. After unpacking please check for any damage. It is rare that any damage occurs during shipping, but if this does happen contact the shipper.

Quick setup

- 1 Connect the included speaker wire from the left (powered) speaker to the right (passive) speaker.

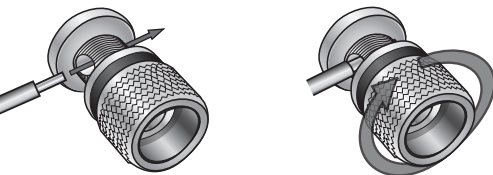

- 2 Connect one of the included audio cables to your music player (phone, tablet, computer, TV, etc.) and the other end to an input on the A5+ rear panel.
- 3 Connect the power cable to the A5+ rear panel and plug the other end into an AC power outlet.
- 4 Turn on the power switch on the rear panel.
- 5 Play your music and adjust the volume on the speakers and your device to the desired listening levels.

Inputs and volume settings

Multiple sources and devices may be connected to the speakers at the same time and all inputs are open and active so it's easy to switch between your tablet, phone, TV, or any other device.

To adjust the volume, we recommend you first set a level on the A5+ and then use the volume control directly on your device to adjust the overall level. Volume settings are flexible and there is no right or wrong so feel free to experiment to find levels that work for you.

Break-in Period

Your speakers will sound great out of the box and will get better over time. No need to do anything else but listen to them. We do recommend that you give them at least 40 to 50 hours break-in time before doing any critical listening.

Cleaning

We don't recommend using any solvents or cleaners. Just wipe down the cabinets with a soft, dry cloth.

Other Features

Variable output

The A5+ includes a variable full-range preamp audio output so you can connect a subwoofer, other Audioengine powered speakers or an Audioengine wireless adapter to stream music to other systems around your house. This output is variable (adjustable) so the volume level of the output can be controlled from the A5+ front panel or remote control.

Stand mounting

Threaded 1/4"x 20 brass inserts are included on the bottom of each speaker cabinet to provide the ability to attach the speakers to floor stands. These inserts are not designed to support the full weight of the speakers and therefore should not be used with single-point wall or ceiling mounts.

It is the customer's responsibility to check with the speaker stand manufacturer to determine whether that specific stand is capable of handling the weight and proportions of these speakers in a safe and stable manner. The customer is also responsible for proper selection of mounting hardware not included with the speaker and for proper assembly. Audioengine disclaims any liability for the selection of suitable floor stands and/or correct hardware between the selected stand and these speakers.

Extra tips, troubleshooting, FAQs and updates to this guide can be found on our website: audioengine.com/support-inquiry

Product returns and refunds

We sincerely hope you get as much enjoyment from our products as we've had creating them. However, should you have an issue or are not satisfied with any Audioengine product for any reason contact the reseller where you purchased or contact us directly: audioengine.com/support-inquiry

Speaker Placement

Although your A5+ speakers are very forgiving with regards to placement, it's true that proper speaker location can have an impact on sound quality. There seem to be different theories on correct speaker placement but rooms and tastes are different so it's difficult to recommend a perfect setup. We do suggest you feel free to experiment to see what works for you.

As a general rule of thumb for the best soundstage and imaging, the speakers should be equidistant from side walls and a different distance from rear walls. Tweeters should be at about eye-level in your most frequent listening location and for the best bass response we recommend at least 6 inches of clearance between the rear of the speakers and the wall behind them.

Here are a few more suggestions, assuming you have some flexibility regarding where you place your speakers. No need for concern if your situation and listening environment dictate the speakers' position.

Both speakers should be equidistant from your primary listening position.

Placing the speakers at least 6 feet (1.8m) apart usually provides the best imaging.

Try to keep the speakers near the front edge of shelves or cabinets.

Allow at least 6 inches of clearance between the rear of the speakers and the wall or surface behind them.

If you need to turn the speakers on their sides, position the tweeters toward the outside.

If used on a desktop for computer speakers, it's best if they are placed on a solid surface.

Remote Control

Sleep
Sleep mode is a power-saving feature, shown by a slow pulse of the front panel power indicator. To exit Sleep, press the Sleep button again. You can also put the A5+ into and out of Sleep by pressing the front panel volume knob.

Mute
Press the Mute button to silence the A5+. The front panel indicator will blink showing that the speaker is muted. Mute may also be cancelled by pressing the Volume (+) or (-) or by turning the front panel volume knob.

Volume
Press Volume (+) or (-) to adjust the A5+ volume level.

WARNING: DO NOT INGEST BATTERY, CHEMICAL BURN HAZARD.



Button battery inside this product.

A5+ Classic (left) speaker front

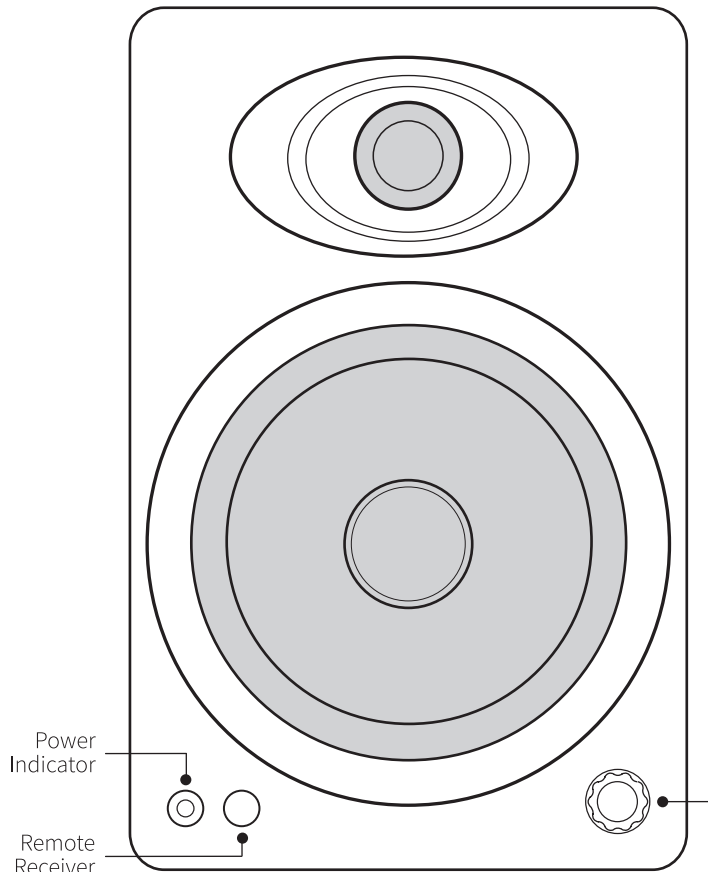

A5+ Classic (left) speaker rear

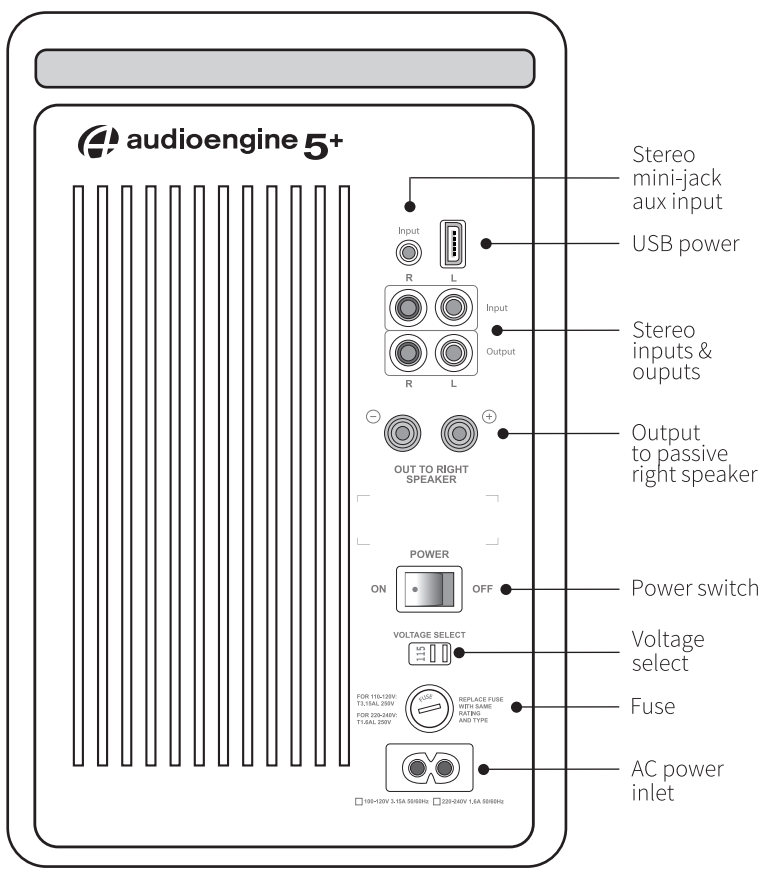

Warranty information

All Audioengine products have a 3-year Limited Warranty on parts and labor from the date of purchase. The Limited Warranty applies only to Audioengine products sold in the United States. Your warranty is automatic, so there is no need to register. For Limited Warranty coverage elsewhere, please contact the Audioengine dealer, reseller, or distributor in your country or region.

What is covered

All defective parts or faulty workmanship.

What is not covered

The Audioengine Limited Warranty does not cover damage caused by accident, misuse, abuse, neglect, excessive moisture, lightning, power surges, other acts of nature, unauthorized product modification or repairs, or failure to follow the instructions outlined in this guide.

What we will do

We will repair or replace any defective parts, at our option, within a reasonable amount of time and free of charge any time during the warranty period. After service, we will be responsible for shipping the product back to you at our expense.

What we ask from you

You will be responsible for shipping charges to Audioengine or to an authorized dealer. We recommend you keep the original shipping materials to prevent shipping damage if service is needed. Audioengine cannot be responsible for any damages incurred during shipping due to poor packing, so please pack well and make sure to insure your shipment.

How to obtain Audioengine warranty service

If you have any questions or feel you may need service, contact the reseller where you purchased your product or visit our support portal: audioengine.com/support-inquiry

And if you don't find an answer to your question you can easily contact us by opening a support ticket.

Exclusive remedy

This Limited Warranty is fully transferable provided the current owner furnishes the proof of purchase and that the serial number on the product is intact. THE MAXIMUM LIABILITY OF AUDIOENGINE SHALL NOT EXCEED THE ACTUAL PURCHASE PRICE PAID BY YOU FOR THE PRODUCT. IN NO EVENT SHALL AUDIOENGINE BE LIABLE FOR SPECIAL, INCIDENTAL, CONSEQUENTIAL OR INDIRECT DAMAGES.



About Audioengine

Audioengine designs and builds innovative audio products with all your music in mind. Great sound, simple but elegant designs, high-quality materials and truly useful features are what Audioengine is about.

FCC Part 15 Notice

This device complies with Part 15 of the FCC Rules. Operation is subject to the following two conditions:

- 1) This device may not cause harmful interference.
- 2) This device must accept any interference received, including interference that may cause undesired operation.

Changes or modifications not expressly approved by the party responsible for compliance could void the user's authority to operate the equipment.

This equipment has been tested and found to comply with the limits for a Class B digital device, pursuant to Part 15 of the FCC Rules. These limits are designed to provide reasonable protection against harmful interference in a residential installation.

This equipment generates, uses, and can radiate radio frequency energy and, if not installed and used in accordance with the instructions, may cause harmful interference to radio communications. However, there is no guarantee that interference will not occur in a particular installation. If this equipment does cause harmful interference to radio or television reception, which can be determined by turning the equipment off and on, the user is encouraged to try to correct the interference by one or more of the following measures:

- Reorient or relocate the receiving antenna.
- Increase the separation between the equipment and receiver.
- Connect the equipment into an outlet on a circuit different from that to which the receiver is connected.
- Consult the dealer or an experienced technician for help.

FCC Radiation Exposure Statement

This equipment complies with FCC radiation exposure limits set forth for an uncontrolled environment. This equipment should be installed and operated with minimum distance 20cm between the radiator & your body.

Information for Users on Disposal of Old Equipment

[European Union]



This symbol indicates that the electrical and electronic equipment should not be disposed as general household waste at its end-of-life. Instead, the product should be handed over to the applicable collection point for the recycling in accordance with your national legislation.

By disposing of this product correctly, you will help to conserve the environment and human health that could otherwise be caused by inappropriate waste handling of this product. For more information about collection point and recycling of this product, please contact your household waste disposal service or the shop where you purchased the product. Penalties may be applicable for incorrect disposal of this waste, in accordance with national legislation.

[Other Countries outside the European Union]

If you wish to dispose of this product, please do so in accordance with applicable national legislation or other rules in your country for the treatment of old electrical and electronic equipment.

© 2022 Audioengine, LLC. All Rights Reserved.

Audioengine and Audioengine A5+ are trademarks of Audioengine.

CE 0700